



Social distance in the workplace with eqWave™

Affordable, easy-to-deploy wearable technology that helps to keep workers safe by enforcing social distancing and providing contact tracing capabilities.

eqWave: social distancing device

New health and safety requirements mean that keeping our distance at work is essential to staff welfare and keeping the workplace open.

Equivalital's eqWave enables your workforce to adhere to social distancing guidelines and continue to do their jobs effectively with peace of mind.

Additional contact tracing capabilities gives you the data you need to control the spread of the virus should an employee become infected.

The eqWave device must be worn by all staff and will alert if they get within a pre-specified distance that can be configured to current government guidelines.

Accurate distance measurements are made using Ultra Wide Band (UWB) giving centimeter levels of precision. Unlike other systems that are based on Bluetooth alone, the eqWave gives 360 degree coverage.

The measurement accuracy is less likely to be compromised by interference from wearers' bodies or objects in the line of sight. No fixed infrastructure is required for deployment of the eqWave solution.

Social distancing wearable

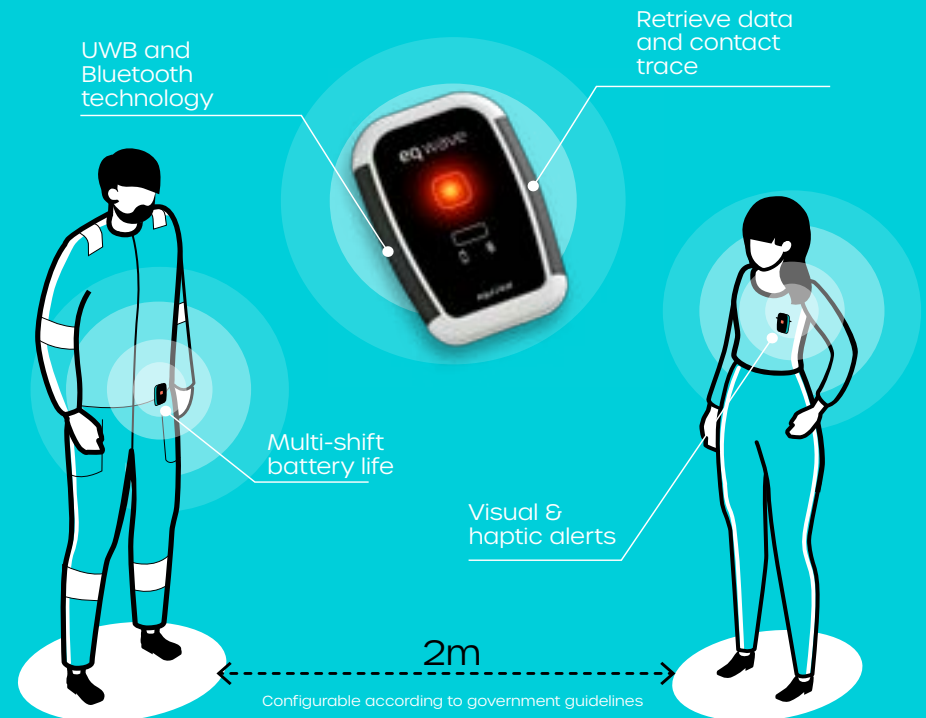

Other applications:

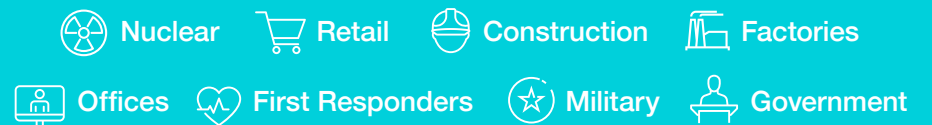

Graphic showing distance alerts of eqWave

How eqWave works for you

1

Wear eqWave

Clip on the eqWave devices

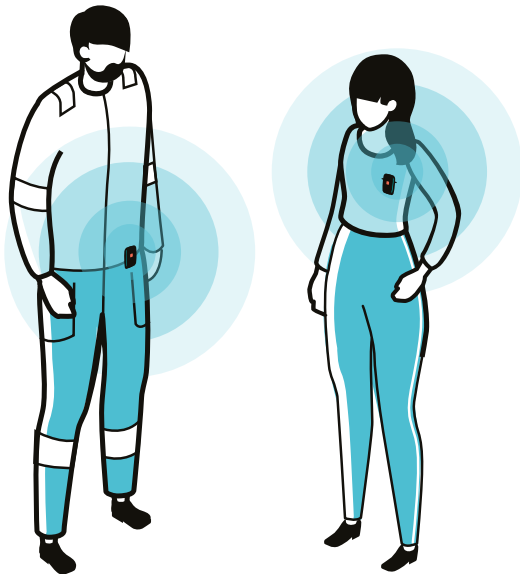

2

Upload eqWave alert data

Scan the QR codes on the eqWave devices using the eqWave Kiosk

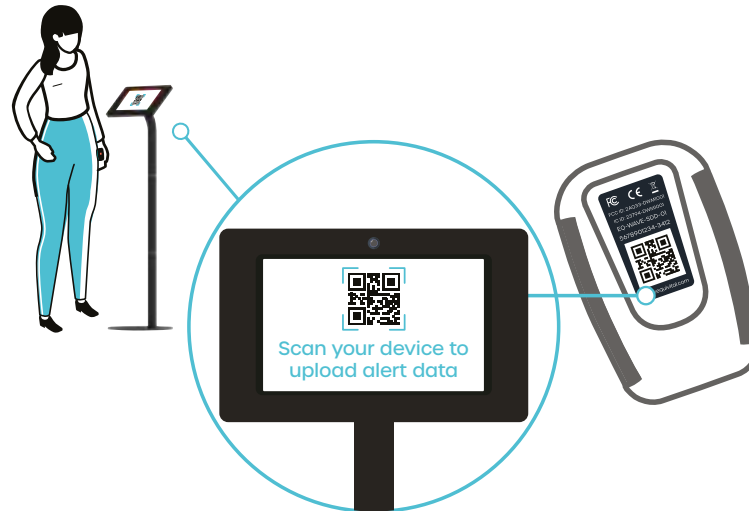

3

Contact tracing

Contact tracing is available and can be accessed for each subject

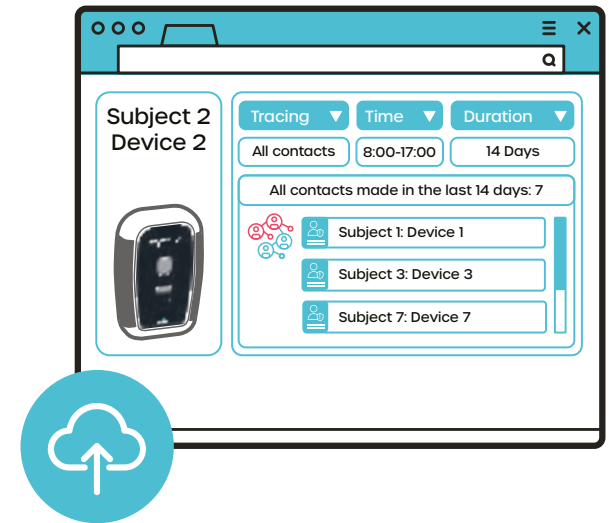

eqWave solution overview

All contact data is collected and stored on the eqWave device.

Data can be downloaded to the Kiosk, if required, where it is queued until transmitted to the website. The eqWave Android Kiosk application is available to download for free from the Google Play Store.

Data is securely stored and can be viewed and exported for contact tracing using the eqWave or eqWave+ web service.

Choose the right web service

There are two options available to view and access your contact tracing data. Choose the right web service to suit your needs.

eqWave

The eqWave web service application is included with all eqWave devices as a 12 month subscription.

The eqWave free service is perfect for accessing the raw log data that you can download for your own analysis.

Customers can upgrade their subscription to the eqWave+ on a monthly basis.

eqWave+

eqWave+ is a premium service that offers intuitive contact tracing reports.

Contact tracing reports can be filtered by duration of contact as well as time and date to allow for meaningful data evaluation.

Web service specifications

| | eqWave | eqWave+ |
|--------------------------------------------------------|--------|---------|
| Retrieve alert data log from all sensors | ✓* | ✓ |
| Export alert data log | ✓* | ✓ |
| Access alert logs via API into your analytics platform | ✓* | ✓ |
| Modify sensor configuration | ✓ | ✓ |
| Push software updates to all eqWave sensors | ✓ | ✓ |
| Zero touch kiosk style interface with Android app | ✓ | ✓ |
| Contact tracing reports and exports | | ✓ |
| On premise hosting | | ✓ |

*Up to 28 days

eqWave partner application

APIs are available for businesses who wish to build the eqWave into their existing connected worker systems.

eqWave partner app offers:

- ✓ Partner support prior to Over the Air (OTA) firmware upgrades
- ✓ Additional support to ensure the end-to-end solution is flight ready

eqWave solution key features

- ✓ A complete end to end solution to keep your staff safe
- ✓ Simple, optional process for data upload
- ✓ Web based contact tracing
- ✓ The option to build your own contact tracing reports
- ✓ GDPR compliant secure data storage

eqWave device key features



Inspire your workers and show you've got their best interests at heart. Contact us now to [arrange a demo on 01954 233 430](tel:01954233430) or email info@equivital.com



@Equivital equivital.com
 T +44 (0)1954 233 430 E info@equivital.com
 Unit F, Trinity Court, Buckingway Business Park,
 Anderson Road, Cambridge CB24 4UQ
 EQ-000441-MB-6

eqWave device specifications

| | | |
|---------------------------|---------------------------------------------------|-------------------------------------------------------------------|
| Distance measurement | Proprietary Ultra Wide Band | |
| Accuracy of measurement | Less than 20cm | |
| Coverage angles | 360° spherical | |
| Social Distance threshold | 2m / 6 feet (configurable) | |
| Alerts | Visual | High intensity LED |
| | Haptic | Integrated vibration motor |
| | Auditory | Optional |
| Battery | Charging | USB connection supplied with an optional 54 way charger available |
| Connectivity | Bluetooth Low Energy | |
| Weatherproofing | IP67 rated | |
| Impact resistant | BS EN 60068-2-31: 2008: Rough Handling: Free Fall | |
| Size | 50 x 75 x 17mm | |
| Weight | 50g | |
| Certifications | CE marked / FCC / EMC (EN 301 489-1) | |